

- 1** Poke a cycle spoke in the middle of a straw. Make two half cuts 3-cm each way from the middle.

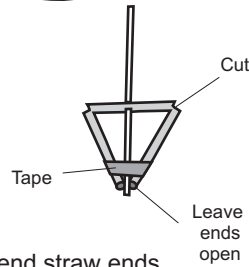

- 2** Bend straw ends in a triangle and tape them to make a sprinkler.

- 3** Wind a wire spring on a refill, then remove the spring.

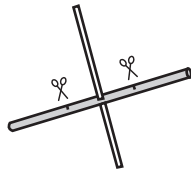
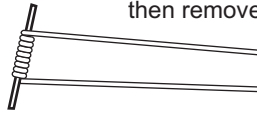

- 4** Twist the ends of the spring and bend them as shown.

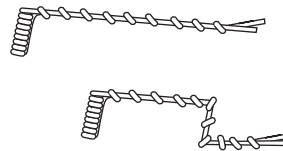

- 5** Attach the twisted arm of the spring to the straw with tape.

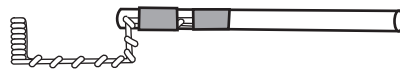

- 6 Place the sprinkler spoke in the spring.
The spoke should be a loose fit in the spring.

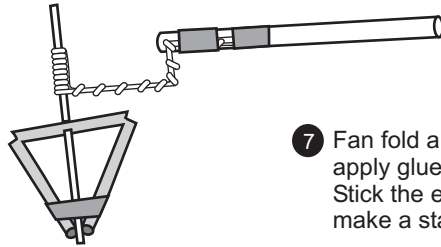

- 7 Fan fold a card strip and apply glue on one side.
Stick the ends of the strip to make a star-shaped turbine.

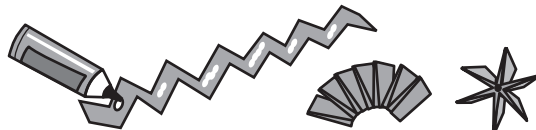

- 8 Fit the turbine on the spoke and glue it in place.

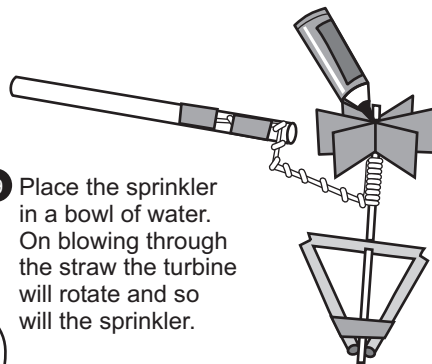

- 9 Place the sprinkler in a bowl of water.
On blowing through the straw the turbine will rotate and so will the sprinkler.

Water climbs up the slant straws of the spinning sprinkler and squirt all over.

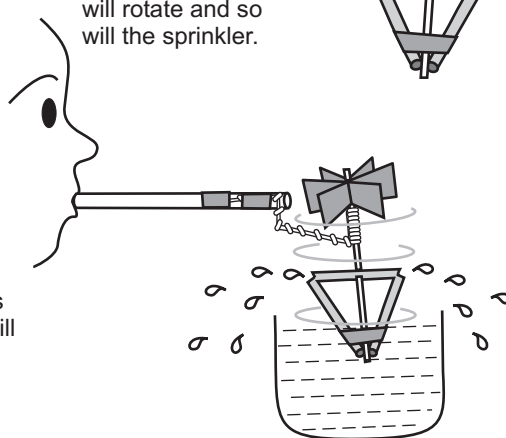

- 10 Water will climb up the slant straws and water drops will squirt all over like a real sprinkler!